



# THE COTTAGE

Hitcham | Suffolk



Chapman Stickels



# THE COTTAGE, WATER RUN, HITCHAM, SUFFOLK, IP7 7LN

A CHARMING, DETACHED GRADE II LISTED COTTAGE SET IN 0.33 ACRES OF PRIVATE GARDENS TOGETHER WITH OFF-ROAD PARKING AND A DETACHED DOUBLE GARAGE

Bildeston - 3 miles

Stowmarket - 6 miles

Hadleigh - 7 miles

- Porch ● Sitting room ● Kitchen ● Utility room ● Garden room ● Shower room ●
- Study/bedroom 3 ● 2 bedrooms ● Large attic space ● Detached garage ●
- Gardens ● Parking ●







## The Property

Located to the northern end of the village, The Cottage is set amongst a cluster of similar period properties which are surrounded by farmland. The property itself probably dates from the early 18th Century and is typical example of its type, where the accommodation is arranged over one and a half storeys. The central part of the cottage comprises the main sitting room with a focal fireplace, where the more modern brick additions could be removed to reveal the original inglenook - subject to listed building consent. Further period features include exposed wall and ceiling beams to the ground floor, and rafters and purlins on the first floor, which comprises two bedrooms to each end of the cottage.

To the rear are a series of single storey extensions which probably date from the 1950's. This includes part of the kitchen which is fitted on two walls with numerous hardwood base and eye level units. The remaining accommodation comprises a rear utility / boot room with shower room with an adjacent garden room. A ground floor bedroom forms part of the original building.

Outside, the generous and private gardens are a feature to the property which are chiefly to the rear (east) comprising a large area of lawn defined by established hedging. Beyond the far eastern hedge is a further secluded area of garden with shed, green house and a dilapidated outhouse which probably dates from when the original cottage was built.

To the front, the cottage is set back in its plot with a front lawn and an adjacent driveway leading to a detached double garage which has power. In all, the property covers some 0.33 acres.

# The Cottage, Water Run, Hitcham, IP7 7LN

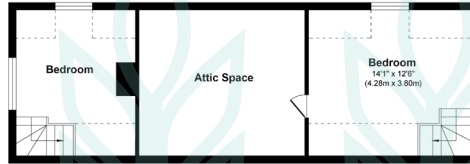

First Floor  
Approximate Floor Area  
222 sq. ft  
(20.62 sq. m)

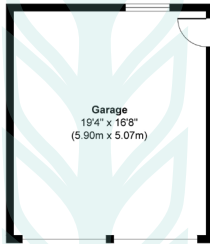

Garage  
Approximate Floor Area  
322 sq. ft  
(29.91 sq. m)

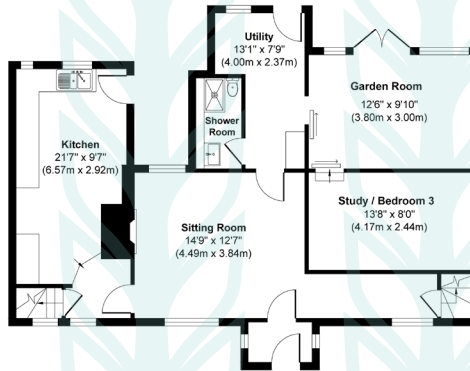

Ground Floor  
Approximate Floor Area  
872 sq. ft  
(81.08 sq. m)

**Approx. Gross Internal Floor Area 1094 sq. ft / 101.70 sq. m**  
**Approx. Gross Internal Garage Area 322 sq. ft / 29.91 sq. m**

Illustration for identification purposes only, measurements are approximate, not to scale.

Copyright of Chapman Stickels Limited

## Services

Mains water, electricity and drainage is connected. Oil-fired heating.

## Local Authority and Council Tax

Babergh & Mid Suffolk District Council.  
Band D.

## Location

Water Run is a hamlet which forms part of Hitcham, which is located some 6 miles southwest of Stowmarket. The village benefits from an excellent village store with post office services and medieval All Saints' Church.

### Chapman Stickels

The Corn Exchange,  
Market Place,  
Hadleigh,  
Suffolk,  
IP7 5DN

info@chapmanstickels.co.uk  
www.chapmanstickels.co.uk

01473 372 372

### All enquiries:

**Benedict Stickels**  
ben@chapmanstickels.co.uk

**Robert Chapman**  
robert@chapmanstickels.co.uk



Scan the QR code to visit our website



rightmove

PrimeLocation.com

onTheMarket.com

Zoopla



**IMPORTANT NOTICE**  
Chapman Stickels states these particulars are for general information only and do not constitute an offer or contract or part thereof. All descriptions, photographs and plans are for guidance only and should not be relied upon as statements or representations of fact. All measurements are approximate where stated. Any prospective purchaser must satisfy themselves of the accuracy of the information within these particulars by inspection or otherwise. Chapman Stickels does not have any authority to give any representations or warranties whatsoever in relation to this property (including but not limited to planning/building restrictions), nor can it enter into any contract on behalf of the client. We do not accept responsibility for any expenses incurred by prospective purchasers in inspecting properties which have been sold, let or withdrawn. If there is anything of particular importance to you, please contact us where we will endeavour to have any information or queries checked.